



A promise made. A promise kept.

The JORDAHL® anchor channels are “Made in Germany“. And this will not change.



Dear JORDAHL customer,

“Made in Germany” is more than just a marketing term. It is a promise of quality. And a denomination of location in Germany. Despite this, the term “Made in Germany” continues to create public discussion – let alone being incorrectly used.

This generates confusion and uncertainty, principally for customers, but also for suppliers and the general public. Through this flyer we wish to inform you that we shall keep our promise with regard to “Made in Germany” and explain how this will be done.

What does “Made in Germany” really mean?

For a long time “Made in Germany” has been a seal of quality that is attached to many products from Germany distinguishing these as first class and reliable. Unfortunately, however, this term is not protected and as a result can be constructed and used in different ways – and thus misleadingly. The term “Made in Germany” is misleading when substantial parts of the product

originate abroad. According to current legal practice, the term “Made in Germany” may only be used if the goods are produced to a significant extent in Germany, have had significant value added by its assembly in Germany or have been significantly refined in Germany.** And it is precisely for this reason that JORDAHL products are “Made in Germany”.



* http://www.anwalt.de/rechtstipps/der-begriff-made-in-germany-in-der-deutschen-rechtsprechung_002036.html

** http://de.wikipedia.org/wiki/Made_in_Germany

http://www.stuttgart.ihk24.de/international/import_export/Warenursprung/Made_in__Warenmarkierung/967062/Made_in_Germany_2.html;jsessionid=8492F3FBAE2045D2F5FCF22F66192D87.repl22

Made in Germany: JORDAHL anchor channels

The JORDAHL® anchor channels are manufactured in our state-of-the-art factory near Berlin using the most modern production systems and – it goes without saying – the highest grade steel. As toothed and non-toothed variants they create, together with the matching JORDAHL® bolts, a multi-purpose and proven connection system.

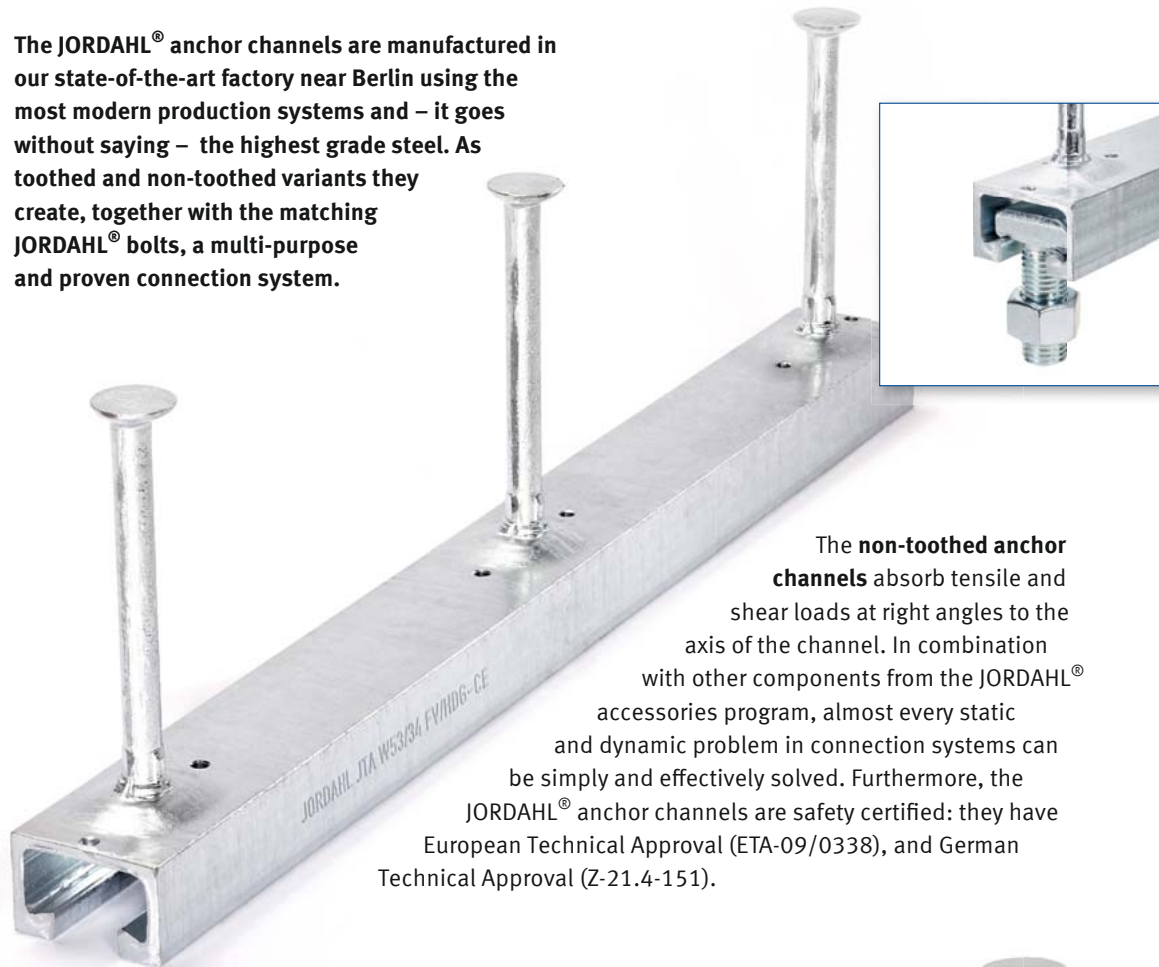

The **non-toothed anchor channels** absorb tensile and shear loads at right angles to the axis of the channel. In combination with other components from the JORDAHL® accessories program, almost every static and dynamic problem in connection systems can be simply and effectively solved. Furthermore, the JORDAHL® anchor channels are safety certified: they have European Technical Approval (ETA-09/0338), and German Technical Approval (Z-21.4-151).

The **JORDAHL toothed anchor channels** can absorb loads from all direction. Combined with the associated toothed bolts this produces a reliable, form-fit connection without slipping. For non-static loading, the toothed JORDAHL® anchor channels offer the highest dynamic load capacity in their load group. The toothed JORDAHL® anchor channels have German Technical Approval, number Z-21.4-1690.

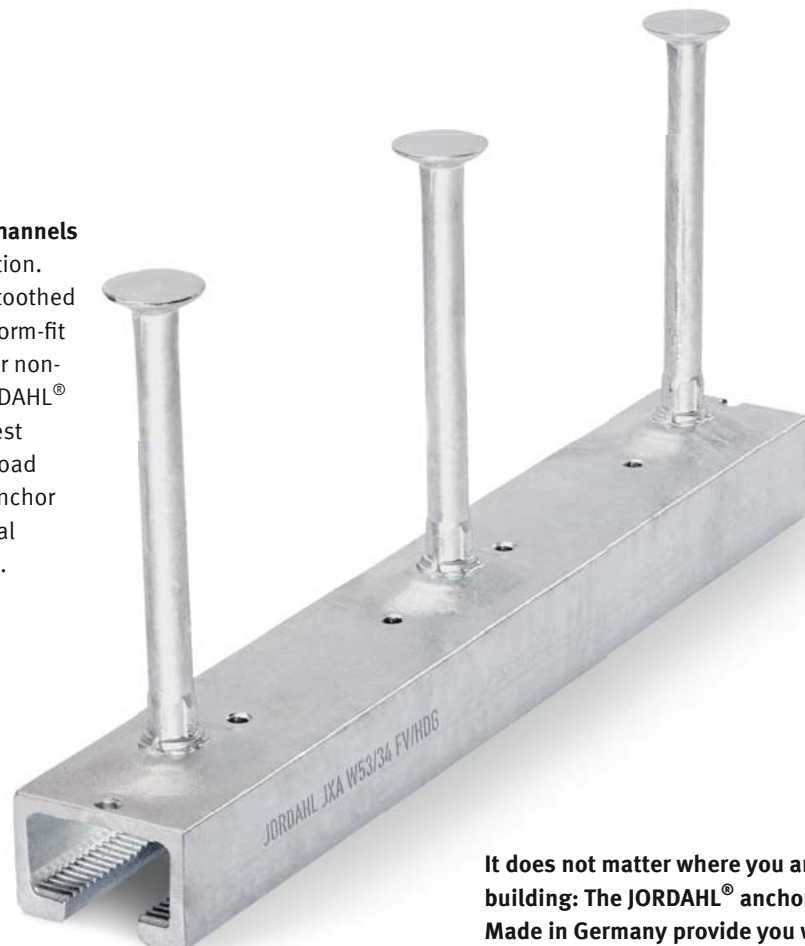

It does not matter where you are building: The JORDAHL® anchor channels Made in Germany provide you with certified safety at all times.

The advantages

- Simple installation
- Anchoring without damaging the concrete or the reinforcement
- Suitable for pre-tensioned structural elements
- Suitable for cracked or non-cracked concrete
- Fast and efficient on-site emplacement
- Assembly using simple tools
- Easy adjustment
- 3-6 load classes
- Increased load capacity close to the reinforcement
- Certified reliability with German and European Approvals
- Customised solutions available



Curved anchor channel pair for safe fastening of catenaries in railway tunnels



Overhead line fastening, Geisberg tunnel, Germany

Customised solutions

Impossible? Not for us. We already have JORDAHL® anchor channels in numerous, special variants. Moreover, our professional team of experts will be delighted to develop the appropriate and ideal solution to meet your particular individual requirements.

- Curved anchor channels
- Anchor channel pairs
- Anchor channel corner pieces
- Lengths from 100 - 6,000 mm

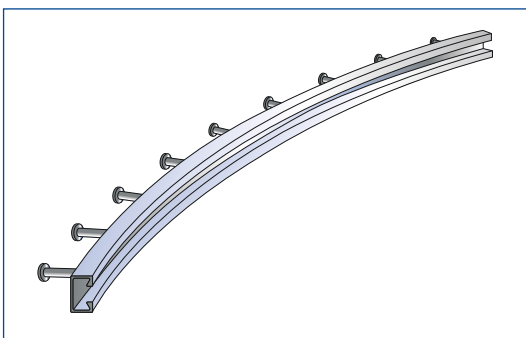

Curved anchor channels, e.g. in railway tunnels

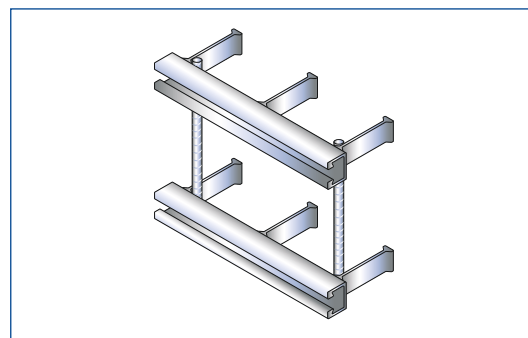

Anchor channel pairs for emplacement of catenaries in railway tunnels

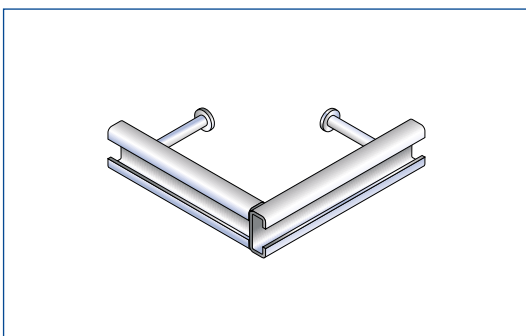

Corner piece

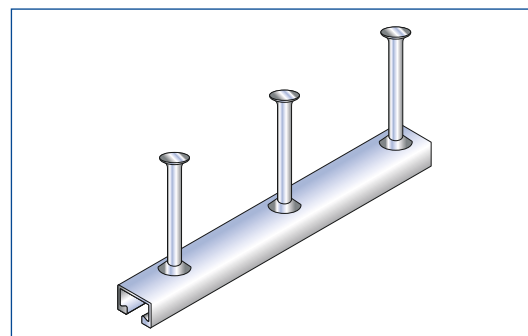

Straight anchor channels available in lengths from 100 to 6,000 mm

Application examples and references

Reliable, multi-purpose and very flexible: the advantages of JORDAHL® anchor channels are plain to see. Hence they are used all over the world – for small and medium-sized as well as large, prestigious projects.



Canary Wharf, London, UK: JORDAHL supplied JTA anchor channels for the façade connection – Photo by David Iliff



Metropolitan, Warsaw, Poland: Toothed and non-toothed JORDAHL® anchor channels are used for reliable fastening of the glass façade elements



Marina Bay Sands Resort & Casino, Singapore: JORDAHL® anchor channels for fastening the glass façade elements – Photo by Stefano

100 years of experience



At JORDAHL the needs of the customers and the development of new, innovative products have always taken precedence. Thus, in 1913, Anders Jordahl developed the anchor channels now bearing his name - a revolution in connection systems and still, today, the main JORDAHL product. JORDAHL has almost 100 years of experience in the production of anchor channels.

100 years in which we have continuously improved our product and adapted it to the requirements of our customers, while supplying consistently high quality at all times.

These days, in an age of a global market, international projects and international competition, quality plays a fundamental role. This is how competitors are differentiated. Thus, the “Made in Germany” seal of quality often becomes the decisive criterion. For it is precisely in the case of construction projects where the safety of many people is a concern that it is important to be able to rely on the quality of a product – not only in Germany but everywhere in the world.

You can rely on JORDAHL® anchor channels “Made in Germany”.

Contact options

If you would like more information, have questions or have already decided to use the JORDAHL® anchor channels, simply get in touch with us. We look forward to hearing from you.

Deutsche Kahneisen Gesellschaft mbH

Nobelstraße 51
12057 Berlin
Germany

phone: 0049 30 6 82 83-02

fax: 0049 30 6 82 83-4 97

info@jordahl.de

www.jordahl.de/home



info@jordahl.de | www.jordahl.de